

**NOTES:**  
 1. THE APPLICANT HAS BEEN ADVISED THAT THE CITY OF PHOENIX HAS A POLICY OF REVIEWING ALL PROPOSED DEVELOPMENT PROJECTS FOR COMPLIANCE WITH THE CITY OF PHOENIX'S SUSTAINABLE DEVELOPMENT POLICY. THE APPLICANT IS ADVISED THAT THE CITY OF PHOENIX'S SUSTAINABLE DEVELOPMENT POLICY IS A POLICY THAT IS DESIGNED TO PROMOTE SUSTAINABLE DEVELOPMENT AND TO PROTECT THE ENVIRONMENT. THE APPLICANT IS ADVISED THAT THE CITY OF PHOENIX'S SUSTAINABLE DEVELOPMENT POLICY IS A POLICY THAT IS DESIGNED TO PROMOTE SUSTAINABLE DEVELOPMENT AND TO PROTECT THE ENVIRONMENT.

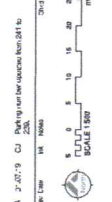
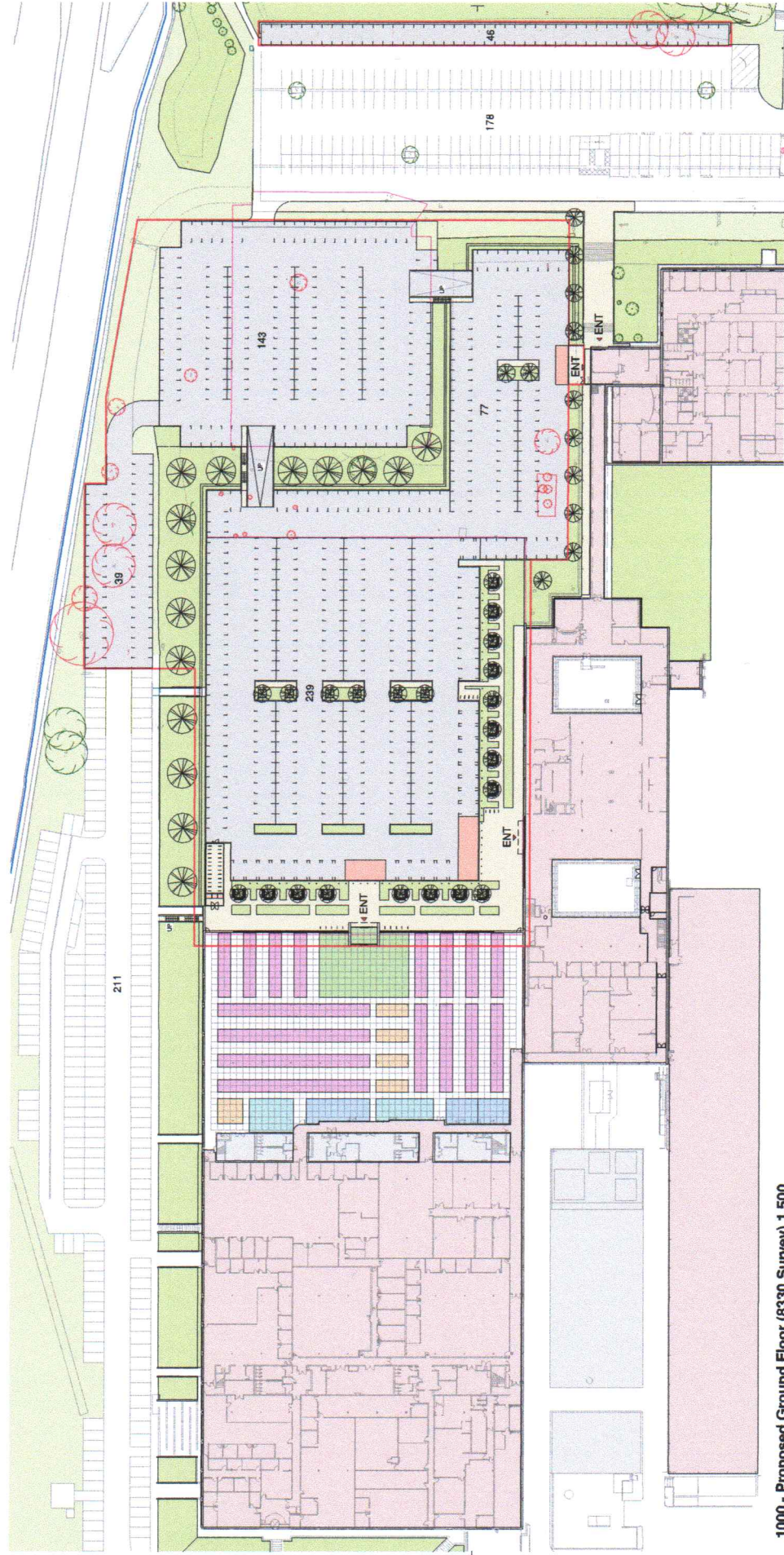

**1000 - Proposed Ground Floor (8330 Survey) 1:500**

- APPLICANT OWNERSHIP BOUNDARY
- EDGE OF EXISTING SLAB / PARKING AREA
- 1500(1500mm) OFFICE GRID
- ELEMENTS REMOVED
- EXISTING GIA
- RECEPTION / ENTRANCE
- OPEN PLAN WORK STATION
- BREAKOUT / INFORMAL
- CONFERENCE / MEETING / FORMAL
- KITCHEN / WC / SERVICES
- EXISTING CORE (PLANT / WC / ST)

**inspired environments**  
 2000 N. 108TH AVENUE, SUITE 100, PHOENIX, AZ 85028  
 TEL: 602.998.1000  
 WWW.INSPIREDEVELOPMENT.COM

**Langstone Technology Park,  
 Building 1000**

**Proposed Ground Floor Plan**

Scale:	1:500	Sheet:	A1	CU	U	14.06.19	
Project:	PLANNING	Phase No.:	4D48A	Drawn By:	MBP/ST	Sheet No.:	200
Client:	Langstone Technology Park	Project No.:		Scale:		Revision:	A